



BASS

■ Non-lubricant Slide Core Unit - Advantage

- This slide unit leads the angular pin to slide in smooth way when core moves inclined injection including any undercut.
- This slide unit adjusts by itself center, therefore it prevent wear and stick of the guide and the slide plate.



Provides extension of slide part by 5mm

No.	Description	Q'ty	Material
1	Slide Block	2	SCM440
2	Core Shaft Block	1	SCM440
3	Guide Plate	2	#500SP(CAC304+Gr)
3	Guide Plate	2	SKD61 HRC 58
4	Stopper Plate	2	SS41

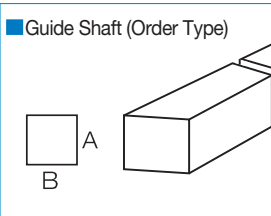
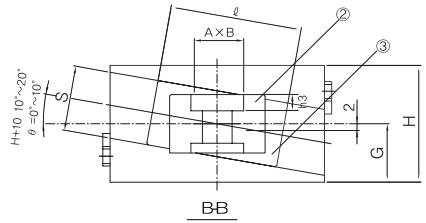
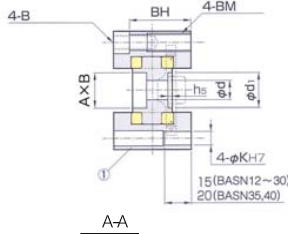
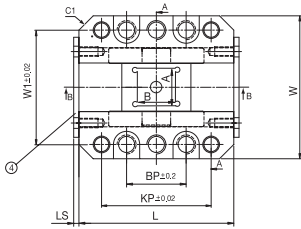

Order → Catalog Code □ A × B ^{+0.05}/_{+0.1} θ SKD 61

BASS 25 - 25 × 15 - 3°
 BASS 25 - 20 × 25 - 0°
 BASS 25 - 20 × 25 - D

Catalog No.	∅ D	h5	C1	C2	Ls	Ⓐ	Ⓑ	Over 10° (θ)
BASS	12	-	5	-	4.65	0° ~ 10°	0°	Quotation by drawing
	16	3	6	-	4.65	0° ~ 10°	-	
	20	5.5	6	5	4.65	0° ~ 10°	-	
	25	5.5	6	5	4.65	0° ~ 10°	-	H+10
	30	3.5	6	5	4.65	0° ~ 10°	-	
	35	4	6	5	5.20	0° ~ 10°	-	
	40	4	6	5	5.20	0° ~ 10°	-	

※Over 10.1° (θ) Quotation by drawing

∅ D	□ D	W	L	H	W1	BP	KP	G	h3	ℓ	S	B	BH	BM	∅ K	D1	∅ d	∅ d1
8	8 × 8	42	46	30	34	16	32	15	4	30	16	M4	23.5	M6	4	7	5.5	-
10	10 × 10	42	46	30	34	16	32	15	4	30	16	M4	23.5	M6	4	9	5.5	-
12	12 × 12	56	55	35	45	21	42	17.5	4	35	20	M6	27.5	M8	6	11	5.5	-
16	16 × 16	60	65	36	48	25	46	18	5	40	20	M6	28.5	M8	6	15	9	16
20	20 × 20	68	70	43	55	25	50	21.5	5	40	24	M8	33.5	M10	8	18	11	20
25	25 × 25	75	80	45	62	35	60	22.5	6	45	26	M8	35.5	M10	8	22	11	20
30	30 × 30	81	95	54	68	50	75	27	6	55	30	M8	44.5	M10	8	27.5	11	20
35	35 × 35	98	110	60	81	50	85	30	8	70	34	M10	48.5	M12	10	32.5	13	26
40	40 × 40	105	120	64	88	60	95	32	8	80	38	M10	52.5	M12	10	37.5	13	26