



BDSL



■ Non-lubricant Universal Slide Core Unit - Advantage

- This slide unit leads the angular pin to slide in smooth way when core moves inclined injection including any undercut.
- This slide unit adjusts by itself center, therefore it prevents wear and stick of the guide and the slide plate.

No	Description	Q'ty	Material
1	Slide Block	2	SCM440
2	Core shaft Block	1	SCM440
3	Bushing	1	DU
4	Guide Plate	2	#500SP(CAC304+Gr)
5	Key	1	S45C
6	Guide Plate	2	SS41
7	Control Bolt	1	SCM400
8	Fasten Nut	1	SCM400



특허청
CORRECTOR THE KOREAN INTELLECTUAL PROPERTY

Patent No. : 10-0802150



특허청
CORRECTOR THE KOREAN INTELLECTUAL PROPERTY

Patent No. : 10-0887386

Order

Catalog Code D θ Extension ring

BDSL - 25 - 0° - 5
TOOL BCL - 25

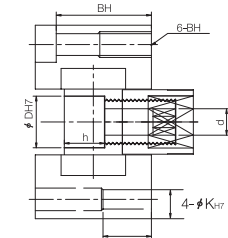
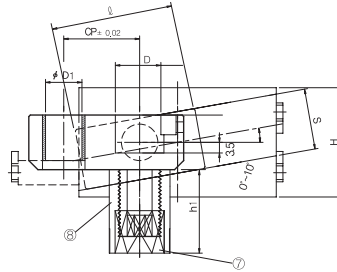
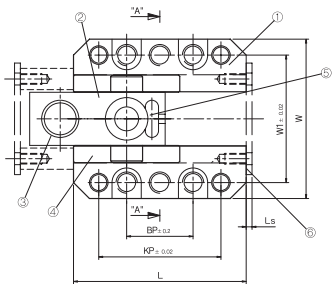

※ Assembling Manual - page 66~67

■ Fitting (Description)

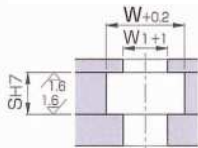

■ Guide Shaft BGPA BGPM

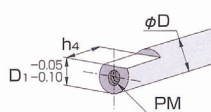

φ D	Ls	Ⓐ	Ⓑ	Over10,1° (θ)
12	4,65	0° ~ 10°	0°	H+10
16	4,65	0° ~ 10°	-	
20	4,65	0° ~ 10°	-	
25	4,65	0° ~ 10°	-	
30	4,65	0° ~ 10°	-	
35	5,20	0° ~ 10°	-	
40	5,20	0° ~ 10°	-	

φ D	D1	D2	W	L	H	W1	BP	KP	CP	h	ℓ	S	B	BH	BM	φ K	h1	φ d
12	10	11	56	55	35	45	21	42	20	11,5	35	20	M6	27,5	M8	6	20	5,2
16	12	15	60	65	36	48	25	46	25	12,5	40	20	M6	28,5	M8	6	22	8,2
20	16	18	68	70	43	55	25	50	30	14,5	40	24	M8	33,5	M10	8	25	10,5
25	20	22	75	80	45	62	35	60	35	16,5	45	26	M8	35,5	M10	8	28	12,5
30	25	27,5	81	95	54	68	50	75	40	18,5	55	30	M8	44,5	M10	8	30	12,5
35	30	32,5	98	110	60	81	50	85	45	21,5	70	34	M10	48,5	M12	10	30	16,5
40	35	37,5	105	120	64	88	60	95	50	23,5	80	38	M10	52,5	M12	10	30	16,5