

DIN9834

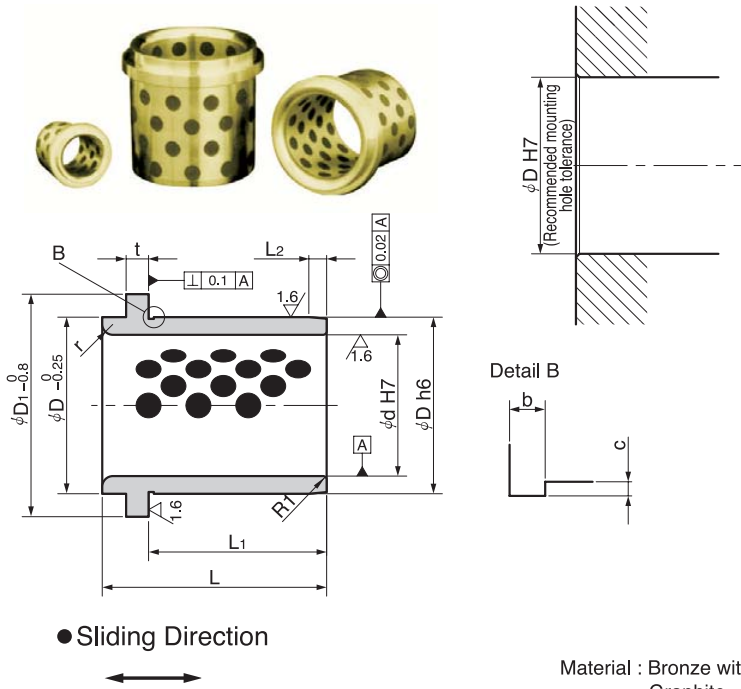

Material : Bronze with Graphite (CAC304+GR)

■ Clamp VDI-KL (DIN9832)

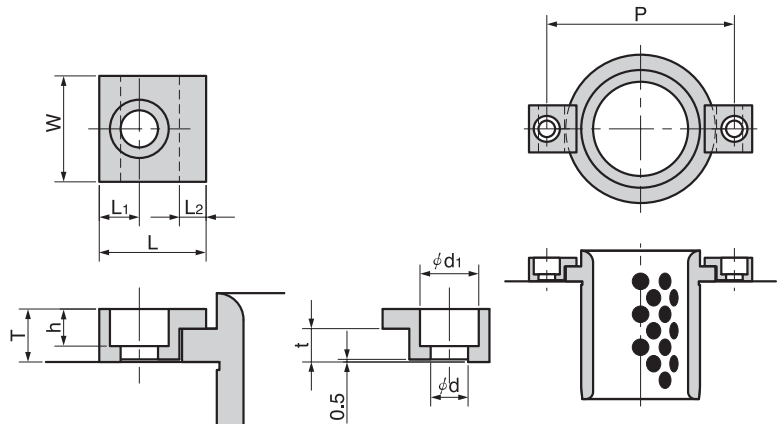

Material : ST37K(Equivalent to SS400)



Catalog No.	d	H7	D	h6	L	D <sub>1</sub>	L <sub>1</sub>	L <sub>2</sub>	t	r	b×c
9834-025	25	$\begin{smallmatrix} +0.021 \\ 0 \end{smallmatrix}$	32		40	40	30	3			
9834-032	32		40	$\begin{smallmatrix} 0 \\ -0.016 \end{smallmatrix}$	50	50	40	4	6.3	3	0.6×0.3
9834-040	40	$\begin{smallmatrix} +0.025 \\ 0 \end{smallmatrix}$	50		63	63	50	5			
9834-050	50		63	$\begin{smallmatrix} 0 \\ -0.019 \end{smallmatrix}$	71	71	56	6.3			
9834-063	63		80		80	90	63	8		6	
9834-080	80	$\begin{smallmatrix} +0.030 \\ 0 \end{smallmatrix}$	100	$\begin{smallmatrix} 0 \\ -0.022 \end{smallmatrix}$	100	112	80	10		8	
9834-100	100		125	$\begin{smallmatrix} 0 \\ -0.025 \end{smallmatrix}$	125	140	106	12.5	10	10	1.0×0.4
9834-125	125	$\begin{smallmatrix} +0.040 \\ 0 \end{smallmatrix}$	160		160	180	132	16			
9834-160	160		200	$\begin{smallmatrix} 0 \\ -0.029 \end{smallmatrix}$	200	220	170	16		18	



Order

Catalog No.

9834-063

### ■ Operating conditions

Allowable maximum surface pressure P (daN/cm <sup>2</sup> )	Allowable maximum speed V (m/min)	Allowable maximum PV value (daN/cm <sup>2</sup> ·m/min)	Operating temperature °C
1000	15	2000	-150~300

### ● Mating material condition

Hardness : min HRC35

Surface roughness :

Ra 0.8 μm or less

### ■ Clamp

Catalog No.	W	L	T	L <sub>1</sub>	L <sub>2</sub>	t	d	d <sub>1</sub>	h	Applicable post diameter
VDI-KL- 6	20	20	10	7.5	5	6.3	7	11	7	φ25~ φ50
VDI-KL-10	32	32	16	11	10	10	11.5	17.5	11.5	φ63~ φ160



Order

Catalog No.

VDI-KL-10

### ■ Clamp mounting hole circle

Bushing Hole Diameter	P
25	58
32	66
40	79
50	89
63	123
80	143
100	168
125	203
160	243