

**BOX** (Sintered and Standard Type) •  $W = 28$  to  $75$

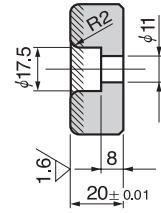

•  $W = 100$  or more

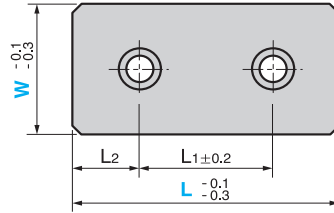
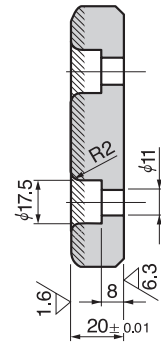
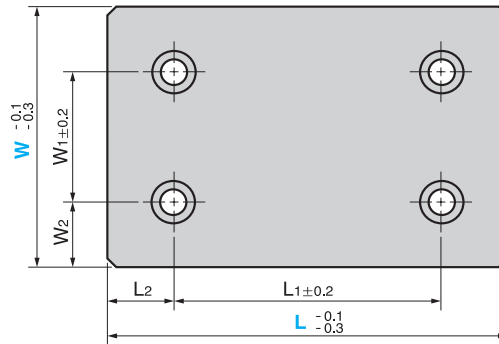

**BOXT** (Sintered □-Hole Type)

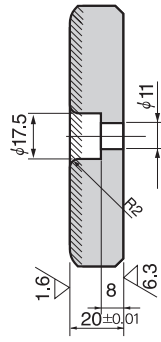
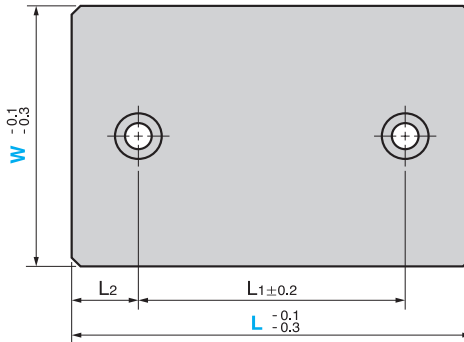

• Sliding Direction



Material : Powder sintered (#200S)  
 Hatched Area Sintered  
 Thickness 1,2 mm or more  
 SS400(base plate)



## Wear Plate – Sintered Type

W <sub>1</sub>	W <sub>2</sub>	L <sub>1</sub>	L <sub>2</sub>	Catalog No.	W	L	
						BOX	BOXT
		45	15			75	
		50	25		28	100	
		100				150	
		45	15				75
		50	25		38	100	
		100				150	
		45	15				75
		50			48	100	
		75	25			125	
—	—	100		BOX		150	—
			50			200	
		45	15			75	
		50			58	100	
		100				150	
		25				75	
		50			75	100	
		75				125	
		100	25			150	
		150			200		
		50				100	100
		75				125	125
50	25	100			100	150	150
		150				200	200
		200	50			250	250
					300	—	
		75		BOX		125	—
		100	25	BOXT		150	150
50	37.5	150				125	200
		200	50			250	250
							300
		100				150	150
100	25	150	25		150	200	200
		200				250	250

\* W<sub>1</sub> and W<sub>2</sub> are the dimensions only for BESF (W = 100 or more).



Order

Catalog No.	W	—	L
BOX	48	—	75
BOXT	125	—	150

■ We are ready to accept requests or orders for special parts.